

## Micro-Adjust Rod

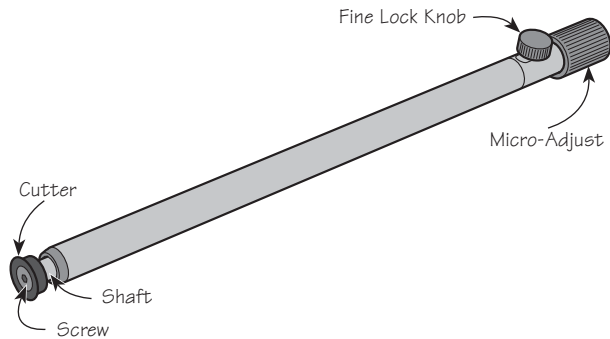

To replace the rod on any marking gauge body with a  $\frac{5}{16}$ " bore:

**Note:** While this micro-adjust rod is compatible with the Veritas® Dual Marking Gauge, only one of the two rods can be replaced.

1. Loosen (but do not remove) the fine lock knob on the new rod.
2. Turn the micro-adjust to fully retract the cutter.

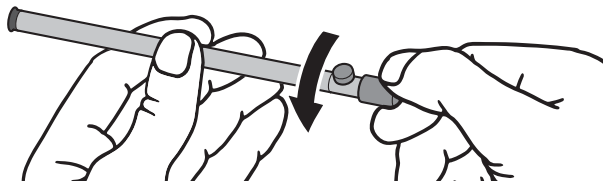

3. Remove the screw and cutter.

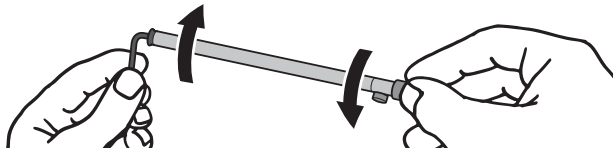

4. Turn the micro-adjust the opposite way to fully project the shaft.

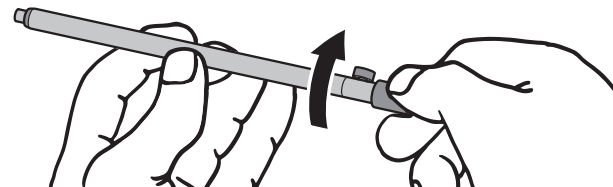

5. Remove the original rod from the marking gauge body.

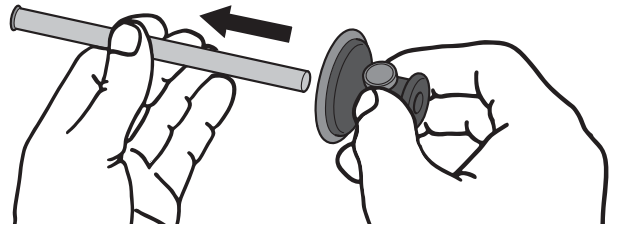

6. Install the new micro-adjust rod in the marking gauge body as shown below.

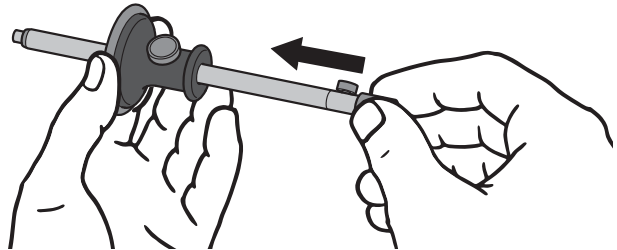

7. Lock the body in position.

8. Reinstall the cutter and the screw, being certain to hold the micro-adjust while tightening the screw.

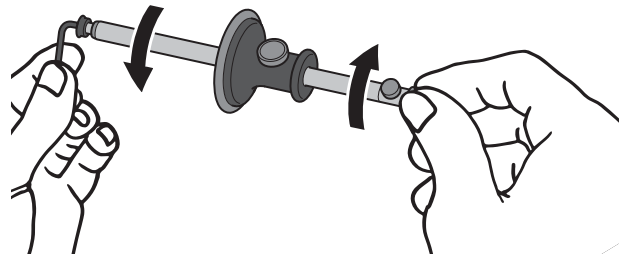

9. Loosen the micro-adjust to break the thread binding that took place as a result of tightening the screw.

